

REV	DATE	DESCRIPTION OF CHANGE	ENG
E	12/7/20	CORRECTED TITLE BLOCK	TC

*ITEM# 12 IS ONLY INCLUDED WHEN ITEM# 3B. IS INCLUDED IN PLACE OF ITEM# 3A. IF ITEM# 3B IS INCLUDED, ITEM# 12 MUST BE INSTALLED BETWEEN ITEM# 4 AND ITEM# 5. IF ITEM# 3A IS INCLUDED, ITEM# 12 IS NOT NEEDED.

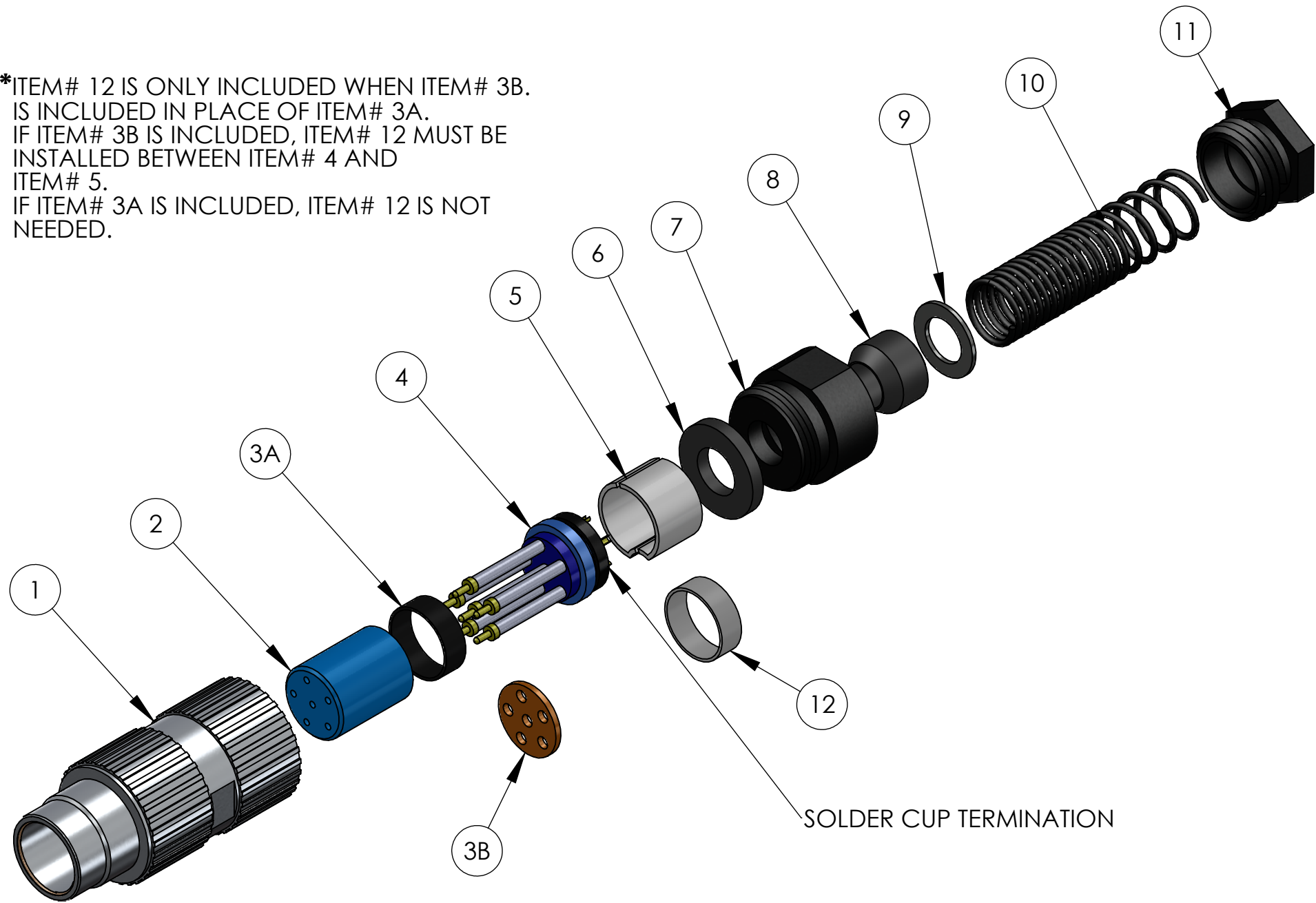

ASSEMBLED VIEW
SCALE: 1:1

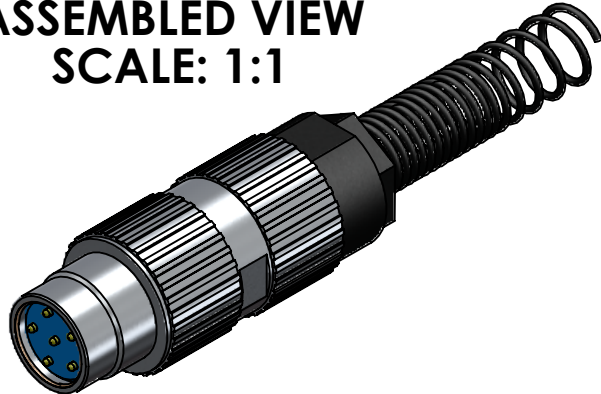

NOTES:
1. MIL-C-55116 SERIES

BILL OF MATERIALS		
ITEM NO.	QTY	NAME/DESCRIPTION
1	1	SHELL
2	1	INSERT ASSEMBLY
3A	1	BLACK SPACER
3B	1	RED SPACER
4	1	PINS & SPING ASSY.
5	1	PLASTIC INSULATOR
6	1	RUBBER GASKET
7	1	A DAPTER NUT
8	1	GROMMET
9	1	WASHER
10	1	SPRING
11	1	CABLE NUT
12	1	WHITE SPACER

U-328/U ASSEMBLY INSTRUCTIONS:

1. SLIDE STRAIN RELIEF SPRING (9) INSIDE THE CABLE NUT(10), AND SLIDE THE CABLE THROUGH THEM BOTH.
2. PLACE METAL WASHER (8) AND RUBBER GROMMET (7) ONTO CABLE
3. PLACE THE APAPTER NUT (6) AND THE GASKET (5) ON NEXT.
4. SLIDE THE TWISTED BRAIDED SHIELDOR DRAIN WIRE INTO GROOVE IN PLASTIC BUSHING AND PULL IT BACK ABOUT 1/4" AND INSERT INTO CONNECTOR SHELL (1), ENSURING THAT SHIELD IS IN CONTACT WITH SHELL TO ENSURE PROPER GROUNDING.
5. PULL CABLE THROUGH WIRE NUT AND STRIP CABLE END AND SOLDER WIRES TO CONNECTOR BODY (4).
6. PLACE CABLE ASSEMBLY PLACE INTO OUTER SHELL (1), ENSURING KEYS LINE UP ALIGNMENT GROOVES IN THE CONNECTOR SHELL.
7. SCREW ADAPTER NUT (6) ONTO OUTER SHELL (1)AND CABLE NUT (10) ONTO WIRE COLLAR TO COMPLETE THE ASSEMBLY. BEST IF USED WITH WIRE DIAMETER OF .250".

UNLESS OTHERWISE SPECIFIED:
DIMENSIONS ARE IN:
TOLERANCES:
.XX: ±
.XXX: ±
ANGULAR:
.X°:
.XX°:

INTERPRET GEOMETRIC TOLERANCING PER:
MATERIAL:
FINISH:

DO NOT SCALE DRAWING

NAME: TC
DATE: 8/22/19
DRAWN:
CHECKED: RB
8/22/19
COMMENTS:

PROPRIETARY AND CONFIDENTIAL
THE INFORMATION CONTAINED IN THIS DRAWING IS THE SOLE PROPERTY OF <INSERT COMPANY NAME HERE>. ANY REPRODUCTION IN PART OR AS A WHOLE WITHOUT THE WRITTEN PERMISSION OF <INSERT COMPANY NAME HERE> IS PROHIBITED.

SupplyNet 706 EXECUTIVE BLVD. SUITE B VALLEY COTTAGE, NY 10989

TITLE:
U-328/U 6-PIN MALE INLINE CONNECTOR

SIZE: **B** DWG. NO.: U-328/U REV: **E**

SCALE: 1:1 WEIGHT: SHEET 1 OF 1