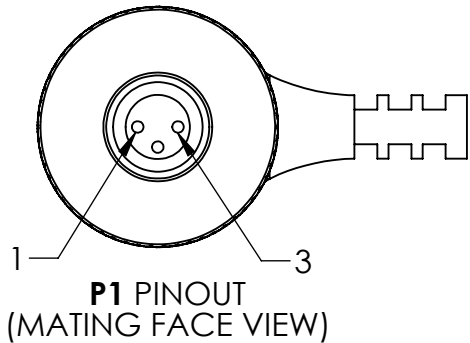
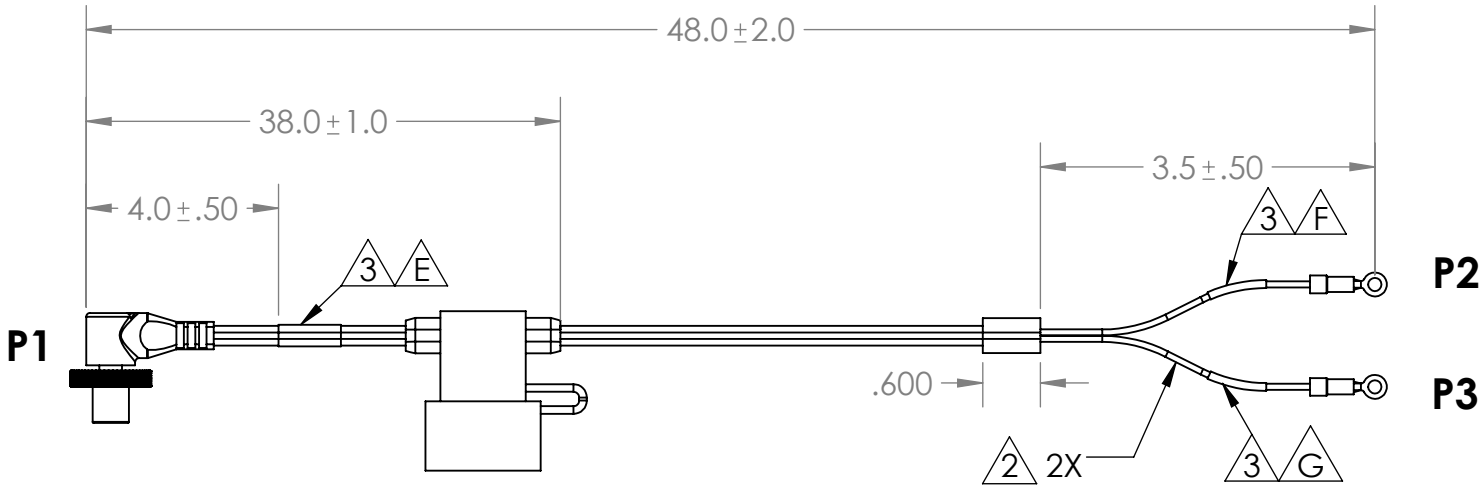

TABLE 1: WIRE RUN		
P1	WIRE COLOR	RING TERMINALS
1	BLACK	P2
3	RED (FUSE)	P3



REVISIONS			
REV.	DESCRIPTION	DATE	ENG
A	RELEASED	08/20/2024	CWA



NOTES:

- WIRING SHALL BE DONE IN ACCORDANCE WITH TABLE 1 WIRE RUN LIST.
- STRIP JACKET 3.5 INCHES AND STRIP CONDUCTORS .197 INCHES.
- MARKING REQUIREMENTS:
 - LABELS SHALL BE MARKED IN ACCORDANCE WITH MIL-STD-130 AS APPLICABLE.
 - LABELS SHALL BE WHITE WITH BLACK TEXT.
 - LABELS SHALL BE PLACED WHERE SHOWN IN DRAWING.
 - ADHESIVE WRAP AROUND LABEL MAY BE USED.
 - LABEL SHALL BE MARKED WITH THE BELOW INFORMATION ONLY. (REV MARKING PER PO)
PN:SN-987-50190C1 REV. X
CAGE: 1HJX9
LOT: TYYYYMMDDPXXXXX
 - LABEL SHALL BE MARKED WITH: - - - - -
 - LABEL SHALL BE MARKED WITH: + + + + +
- PACKAGING REQUIREMENTS:
 - EACH COMPLETED ASSEMBLY SHALL BE PACKAGED IN A ZIP POLYBAG.
 - CONNECTOR(S) SHALL BE PACKAGED TO PREVENT DAMAGE DURING SHIPPING. BUBBLE WRAP OR PROTECTIVE COVER MUST BE USED.
 - POLYBAG SHALL BE MARKED WITH SUPPLYNET LOGO, PRODUCT QR CODE, PART NUMBER, CAGE CODE, AND LOT NO, PER SN-STD-LBL REQUIREMENTS.
- WORKMANSHIP REQUIREMENTS:
 - MANUFACTURE TO IAW/WHMA A-620 CLASS 2 REQUIREMENTS.
 - SOLDERING SHALL BE COMPLIANT WITH IAW J-STD-001 AS APPLICABLE.
 - CONNECTOR(S) AND WIRE SHALL BE FREE FROM ANY SCRATCHES, CHIPS, AND DEFECTS.
- INSPECTION REQUIREMENTS:
 - EACH COMPLETED ASSEMBLY TO BE 100% TESTED FOR SHORTS, CONTINUITY, AND JACKET RESISTANCE (250V @100MOHM MIN.)
 - INSPECT TO IPC/WHMA A-620 CLASS 2 REQUIREMENTS.

UNLESS OTHERWISE SPECIFIED:				REF. NUMBER: SN0629		
DIMENSIONS ARE IN: INCHES TOLERANCES: .XX: ± 0.03 .XXX: ± 0.005 ANGULAR: .X°: 1° .XX°: 0.5° BREAK EDGES: .005 - .020 FILLETS: .005 - .020 SURFACE FINISH: GEOMETRIC TOLERANCING PER: ASME Y14.5 -2009 MATERIAL: SEE DRAWING NOTES FINISH: SEE DRAWING NOTES DO NOT SCALE DRAWING				SupplyNet DESIGN ENGINEERING MANUFACTURING		
				TITLE: DAGR RIGHT ANGLE PWER CABLE, 3A FUSE, RING TERMINALS		
				SIZE B	DWG. NO. SN-987-5019-C1	REV A
				CAGE CODE: 1HJX9		
				SCALE: NA	WEIGHT:	SHEET 1 OF 1