

TABLE 1: WIRE RUN LISTING		
19 CONDUCTOR WIRE		
ITEM 1 (P1) PIN NUMBER	WIRE COLOR	ITEM 3 (P2) PIN NUMBER
13	RED	13
14	YELLOW	14
15	BLUE	15
16	BROWN	16
17	BLACK	17
18	PURPLE	18
19	GRAY	19
20	PINK	20
21	TAN	21
22	LIGHT GREEN *	22
23	LIGHT BLUE *	23
24	GREEN	24
25	WHITE	25
26	DARK ORANGE **	26
27	DARK BLUE **	27
29	DARK GREEN	29
30	CLEAR	30
31	ORANGE	31
32	CLEAR	32
E33, E34	SHIELD	E33, E34
* OPTIONAL WHITE BAND FOR CLARITY		
** OPTIONAL BLACK BAND FOR CLARITY		
12 CONDUCTOR WIRE		
ITEM 1 (P1) PIN NUMBER	WIRE COLOR	ITEM 3 (P2) PIN NUMBER
1	BLACK	1
2	BLACK/WHITE	2
3	BROWN	3
4	BROWN/WHITE	4
5	RED	5
6	RED/WHITE	6
7	ORANGE	7
8	ORANGE/WHITE	8, 28
9	GREEN	9
10	GREEN/WHITE	10
11	YELLOW	11
12	YELLOW/WHITE	12
E33, E34	SHIELD	E33, E34

TABLE 2. WIRE LENGHT LIST	
-XX	LENGTH IN FEET
-01	1 (+/- .5")
-03	3 (+/- .5")
STANDARD	6 (+/- 1")
-12	12 (+/- 1")
-16	16 (+/- 2")
-20	20 (+/- 2.5")
-25	25 (+/- 2.5")
-50	50 (+/- 3.5")

— TWISTED PAIR

— TWISTED PAIR

— TWISTED PAIR

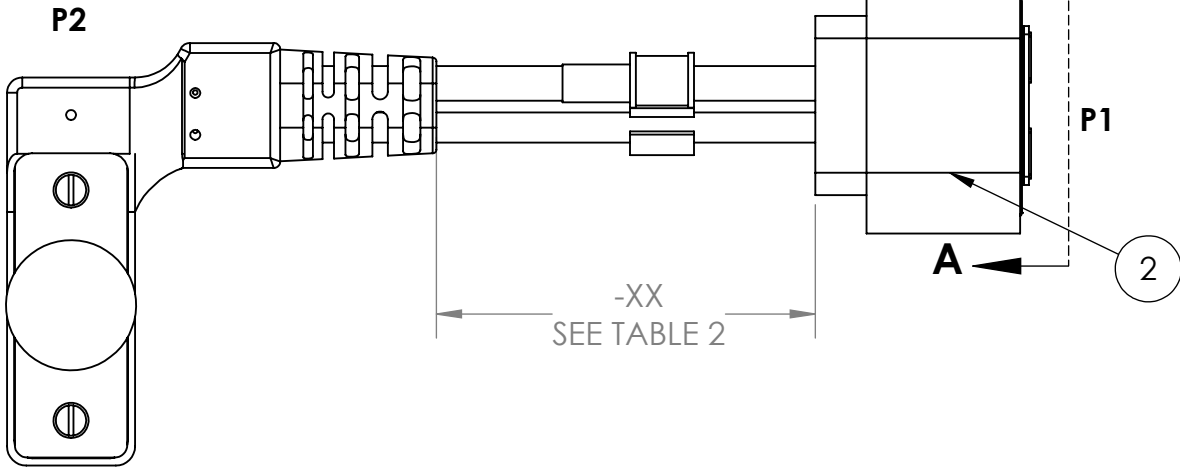

NOTES:

- E33,E34 IS CHASSIS GROUND
- SOLDERING IAW IPC-J-STD-001CLASS II AS APPLICABLE.
- CABLE ASSEMBLIES TO BE 100% TESTEDFOR CONTINUITY, SHORTS AND INSULATION RESISTANCE (250V @100MOHM MINIMUM)
- IDENTIFICATION: BAG ANDIDENTIFY ON PACKAGING THE FOLLOWING INFORMATION FOR EACH PART DELIVERED. UOS PART MARKING ON THE WIRE IS PROHIBITED:  
**PN: SN-271R REV X (REV MARKING PER PO)**  
**CAGE CODE: 1HJX9**  
**DATE OF MFG: MM/YY**
- WIRING FUNCTION: TABLE 1 AND DRAWING
- MANUFACTURE AND INSPECT IAW IPC/WHMA A-620 CLASS 2.

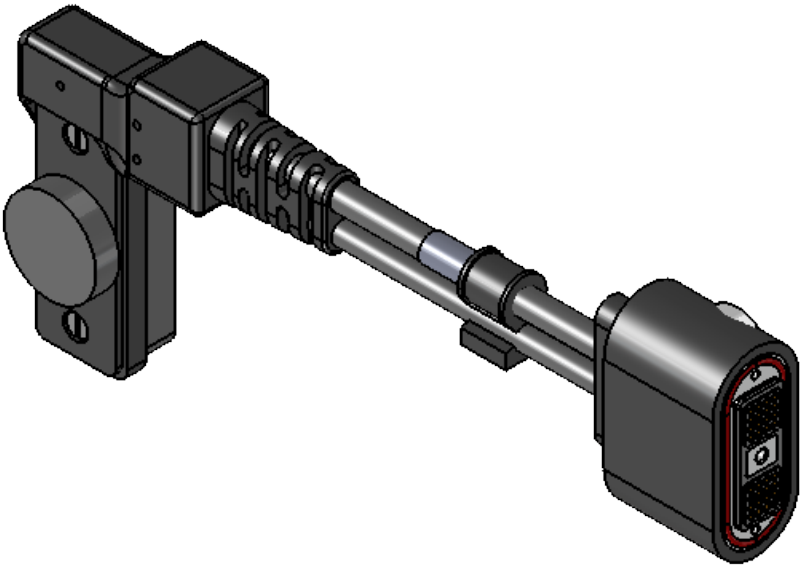

REV	DATE	DESCRIPTION OF CHANGE	ENG
C	12/6/17	UPDATED WIRE COLORS, UPDATED WIRE RUN LIST, UPDATED WIRE LENGTH CHART	LS

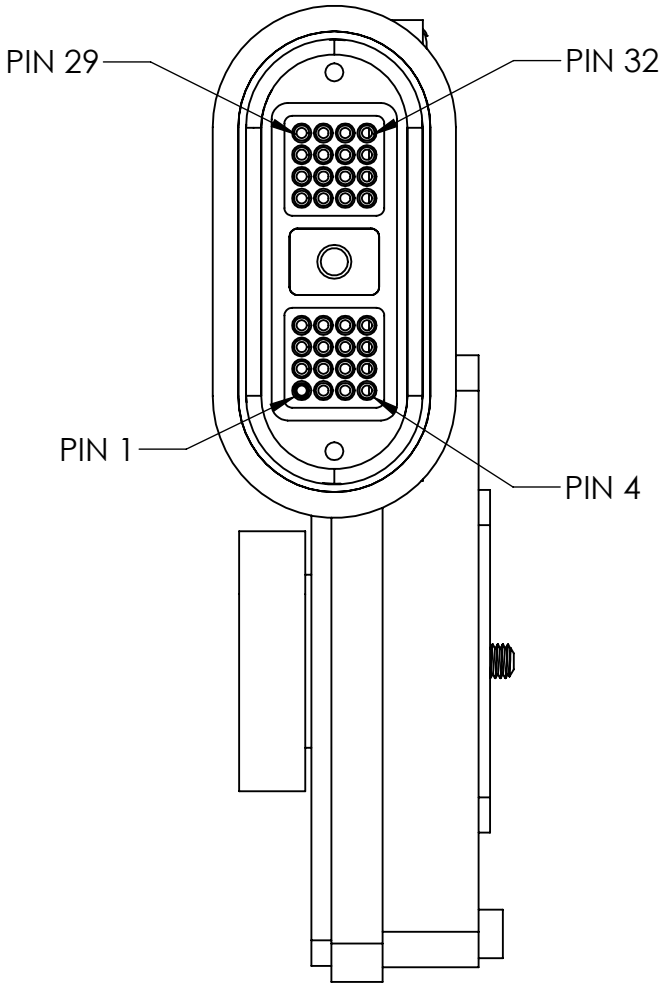

SECTION A-A  
SCALE 1 : 0.75

ITEM NO.	PART NUMBER	QTY	NAME	COMMENTS
1	TE-32ML2-ALL-06	1	CONNECTOR ASSEMBLY	SUPPLYNET FURNISHED.
2	TBD	1	OVERMOLD	STRAIN RELIEF
3	58-001-015	1	RAPID MATE CONNECTOR	SUPPLYNET FURNISHED.

UNLESS OTHERWISE SPECIFIED:			
DIMENSIONS ARE IN: INCHES TOLERANCES: .XX: ± 0.03 .XXX: ± 0.005 ANGULAR: .X*: 1° .XX*: 0.5° BREAK EDGES: .005 - .020 FILLET: .005 - .020 SURFACE FINISH:  GEOMETRIC TOLERANCING PER: ASME Y14.5 -2009  MATERIAL: SEE DRAWING NOTES  FINISH: SEE DRAWING NOTES  DO NOT SCALE DRAWING	DRAWN	TC	05/13/16
	CHECKED	RJB	04/11/13
	COMMENTS:		
	PROPRIETARY AND CONFIDENTIAL THE INFORMATION CONTAINED IN THIS DRAWING IS THE SOLE PROPERTY OF SUPPLYNET, INC. ANY REPRODUCTION IN PART OR AS A WHOLE WITHOUT THE WRITTEN PERMISSION OF SUPPLYNET INC. IS PROHIBITED.		

REF. NUMBER: SN0080			
SupplyNet 706 EXECUTIVE BLVD. SUITE B VALLEY COTTAGE, NY 10989			
TITLE: 90 DEGREE PRC-117G 32 PIN INTERFACE DUAL WIRE CABLE, 6 FT CONNECTED TO RAPID MATE PANEL MOUNT			
SIZE B	DWG. NO. SN-271R	REV C	
SCALE: NA	WEIGHT:	SHEET 1 OF 1	