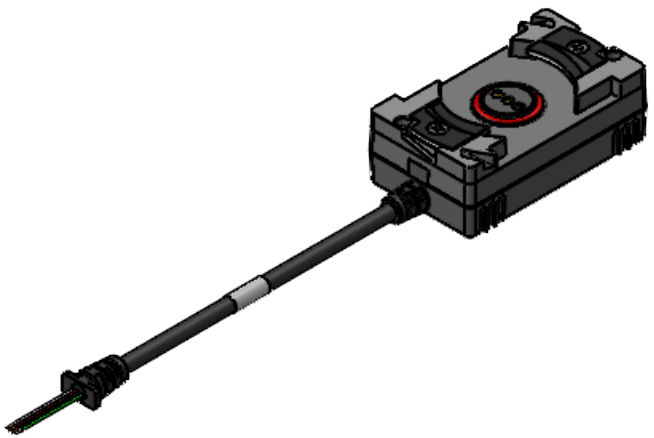
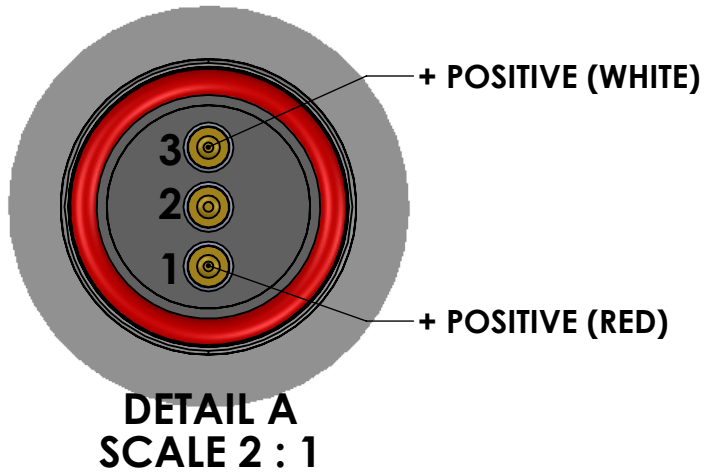
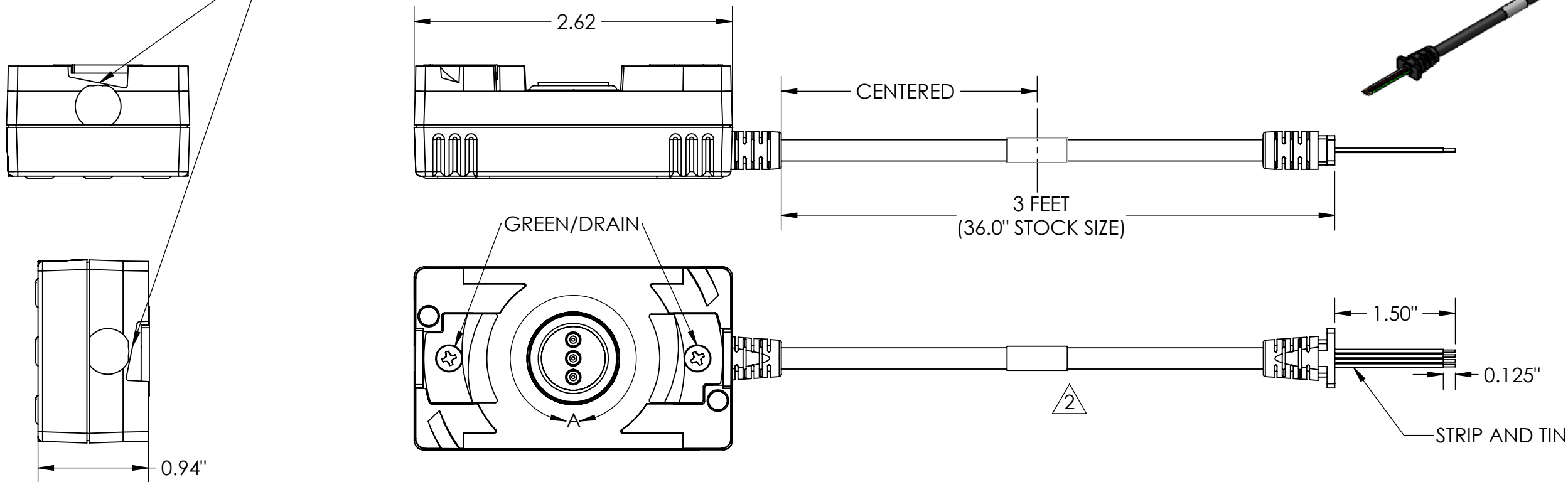

TABLE 1: WIRE RUN LIST	
BATTERY CONN.	WIRE COLOR
+	RED
+	WHITE
-	GREEN
-	DRAIN

REVISIONS			
REV.	DESCRIPTION	DATE	ENG
E	UPDATED MODEL, NOTES & BOM, ADDED PAGE 2	05/23/2024	CWA
F	UPDATED MODEL DIMENSIONS	09/05/2025	CWA
G	UPDATED BOM; ITEM NO. 11	02/10/2026	CWA



SLOT FOR PRC-152 LOCKING LATCH



NOTES:

1. WIRING SHALL BE DONE IN ACCORDANCE WITH TABLE 1 WIRE RUN LIST.

2. MARKING REQUIREMENTS:

- A. LABEL(S) SHALL BE MARKED IN ACCORDANCE WITH MIL-STD-130 AS APPLICABLE.
- B. LABEL(S) SHALL BE WHITE WITH BLACK TEXT.
- C. LABEL(S) SHALL BE PLACED WHERE SHOWN IN DRAWING.
- D. ADHESIVE WRAP AROUND LABEL(S) MAY BE USED.
- E. A LABEL SHALL BE MARKED WITH THE BELOW INFORMATION ONLY. REV MARKING PER PO.
(YYYY=YEAR OF MFG, MM=MONTH OF MFG, DD=DAY OF MFG, XXXX=PO NUMBER)

PN: CONN-MBITER REV.X
CAGE: 1HJX9
LOT: TYYYYMMDDPXXXX

3. PACKAGING REQUIREMENTS:

- A. EACH COMPLETED ASSEMBLY SHALL BE PACKAGED IN A ZIP POLYBAG.
- B. CONNECTOR(S) SHALL BE PACKAGED TO PREVENT DAMAGE DURING SHIPPING. BUBBLE WRAP OR PROTECTIVE COVER MUST BE USED.
- C. POLYBAG SHALL BE MARKED WITH SUPPLYNET LOGO, PRODUCT QR CODE, PART NUMBER, CAGE CODE, AND LOT NO, PER SN-STD-LBL REQUIREMENTS.

4. WORKMANSHIP REQUIREMENTS:

- A. MANUFACTURE TO IAW/WHMA A-620 CLASS 2 REQUIREMENTS.
- B. SOLDERING SHALL BE COMPLIANT WITH IAW J-STD-001 AS APPLICABLE.
- C. CONNECTOR(S) AND WIRE SHALL BE FREE FROM ANY SCRATCHES, CHIPS, AND DEFECTS.

5. INSPECTION REQUIREMENTS:

- A. EACH COMPLETED ASSEMBLY TO BE 100% TESTED FOR SHORTS, CONTINUITY, AND JACKET RESISTANCE (250V @100MOHM MIN.)
- B. INSPECT TO IPC/WHMA A-620 CLASS 2 REQUIREMENTS.

****BOM ON PAGE 2**

REF. NUMBER: SN0256



TITLE:
AN/PRC-148/152 BATTERY ADAPTER CABLE 3 FOOT

SIZE DWG. NO. REV
B CONN-MBITR G

SCALE: NA WEIGHT: SHEET 1 OF 2

UNLESS OTHERWISE SPECIFIED:

DIMENSIONS ARE IN: INCHES
TOLERANCES: .XX: ± 0.03
.XXX: ± 0.005
ANGULAR: .X°: 1°
.XX°: 0.5°
BREAK EDGES: .005 - .020
FILLETS: .005 - .020
SURFACE FINISH:

GEOMETRIC TOLERANCING PER: ASME Y14.5 -2009

MATERIAL: SEE DRAWING NOTES

FINISH: SEE DRAWING NOTES

DO NOT SCALE DRAWING

	NAME	DATE
DRAWN	TC	09/18/14
CHECKED	RJB	09/18/14
COMMENTS:		

PROPRIETARY AND CONFIDENTIAL
THE INFORMATION CONTAINED IN THIS DRAWING IS THE SOLE PROPERTY OF SUPPLYNET, INC. ANY REPRODUCTION IN PART OR AS A WHOLE WITHOUT THE WRITTEN PERMISSION OF SUPPLYNET INC. IS PROHIBITED.

CAGE CODE: 1HJX9

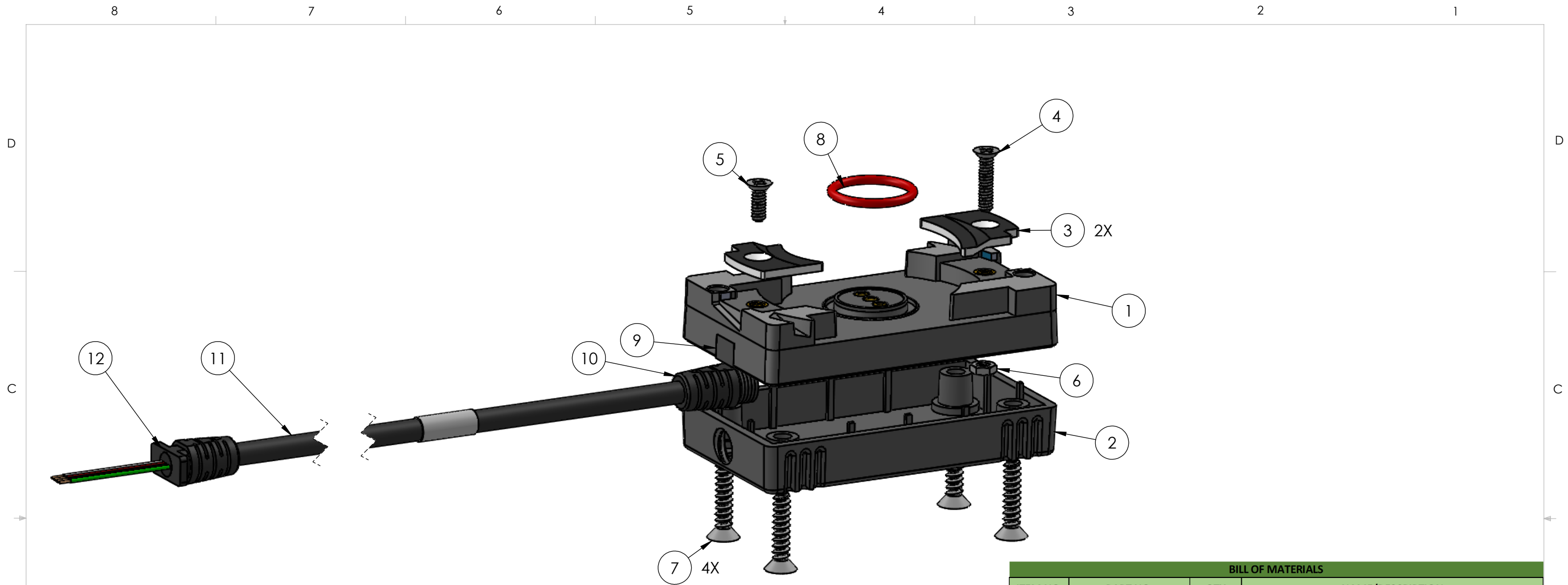

BILL OF MATERIALS			
ITEM NO.	PART NO.	QTY	NAME/DESCRIPTION
1	FE-411-02A2	1	CONNECTOR HOUSING
2	SN-MBITR-DEEP-8MM	1	BACK COVER, DEEP, 8MM THREADED EXIT
3	STEEL-TAB	2	GND TABS
4	67566521 / OR EQUIV.	1	18-8 SS, PHILLIPS FLAT HEAD SCREW, 4-40 x 3/8"
5	91099A160 / OR EQUIV.	1	18-8 SS, PHILLIPS FLAT HEAD SCREW, 4-40 x 1/2"
6	90730A005 / OR EQUIV.	1	4-40 HEX NUT
7	90033A155 / OR EQUIV.	4	PHILLIPS FLAT HEAD SCREW, ZINC PLATED, #6 x 3/4"
8	571-063-R70BT	1	RED BUNA-N O-RING TEFLON COATED
9	SN-831-INSERT	1	PLASTIC INSERT
10	SR:0024	1	8MM STRAIN RELIEF OVERMOLD
11	223C-U01A	38.0"	CABLE, 3C/AWG22/ PU JKT, .197 OD
12	FE-502-11C	1	STRAIN RELIEF FOR CONN-MBITR 5MM

REF. NUMBER: SNO256

UNLESS OTHERWISE SPECIFIED:
 DIMENSIONS ARE IN: INCHES
 TOLERANCES: .XX: ± 0.03
 .XXX: ± 0.005
 ANGULAR: .X°: 1°
 .XX°: 0.5°
 BREAK EDGES: .005 - .020
 FILLETS: .005 - .020
 SURFACE FINISH:
 GEOMETRIC TOLERANCING
 PER: ASME Y14.5 -2009
 MATERIAL: SEE DRAWING NOTES
 FINISH: SEE DRAWING NOTES
 DO NOT SCALE DRAWING

NAME	DATE
DRAWN TC	09/18/14
CHECKED RJB	09/18/14
COMMENTS:	
PROPRIETARY AND CONFIDENTIAL	
THE INFORMATION CONTAINED IN THIS DRAWING IS THE SOLE PROPERTY OF SUPPLYNET, INC. ANY REPRODUCTION IN PART OR AS A WHOLE WITHOUT THE WRITTEN PERMISSION OF SUPPLYNET INC. IS PROHIBITED.	
CAGE CODE: 1HJX9	

SupplyNet		DESIGN ENGINEERING MANUFACTURING	
TITLE:			
AN/PRC-148/152 BATTERY ADAPTER CABLE 3 FOOT			
SIZE	DWG. NO.	REV	
B	CONN-MBITR	G	
SCALE: NA	WEIGHT:	SHEET 2 OF 2	